

## Dear Customer

### ◆ About the Upgrade of the DMC-FX90 Firmware

The following functions were added or changed from firmware Ver. 2.0 for the camera.

Please read this in conjunction with the operating instructions for the camera.

- The firmware version can be checked from the [Version Disp.] of the [Setup] menu.

#### [Live Control] has been added to the menu at recording.

This allows you to connect a smartphone to your camera and view images from your camera on the smartphone. With zoom and shutter operations now available on a control panel displayed on the smartphone, you can remotely record still pictures.

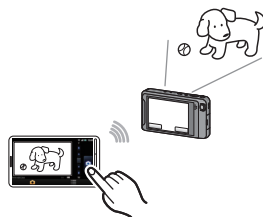

| Menu  | Description of settings  |
|---|--|
|  <b>[Live Control]</b><br>(Recording Mode only) | You can connect the camera to a smartphone and set Live Control. |

To use the Live Control function, installation of the smartphone application “LUMIX remote” is required.

- The smartphone application “LUMIX remote” is required to enable you to view camera images and record still pictures on your smartphone.

#### ■ Install the smartphone application “LUMIX remote”

Download “LUMIX remote” (available free of charge) using the method below.

- 1 Connect the smartphone to the network.
- 2 Search for “LUMIX remote” in the “Google Play™” (formerly “Android™ Market”) (for Android apps) or in “App Store<sup>SM</sup>” (for iOS apps).
- 3 Select “LUMIX remote” and install it.

- The  icon will be added to the menu.



#### Note

- **Compatible OSes (current as of May 2012).**

For Android apps: Android 2.2~Android 4.0

For iOS apps: iOS 4.3~iOS 5.1

- The service may not be able to be used properly depending on the type of smartphone being used. For compatible devices, see the following support site.

<http://panasonic.ip/support/global/cs/dsc/> (This Site is English only.)

- When downloading the application on a mobile network, high packet communication fees may be incurred depending on the details of your contract.
- Android and Google Play are trademarks or registered trademarks of Google Inc.
- App Store is a service mark of Apple Inc.

## ■ Connect your smartphone and camera

### 1 Perform operations on the camera to display the SSID and encryption key.

- In Recording Mode touch [MENU], and then touch [Live Control].

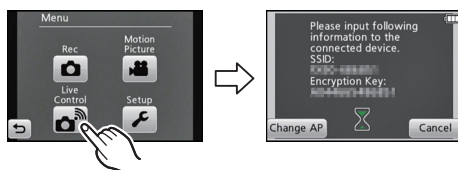

### 2 On the smartphone's Wi-Fi setting screen, set the camera as the connecting device and enter the encryption key displayed on the camera.

- When the connection is completed, a message appears on the camera indicating that live control will be displayed on the smartphone.

### 3 On your smartphone, start the smartphone application "LUMIX remote".

- The recording screen is displayed on the smartphone and [Under remote control] appears on the camera.

#### Note

- Touch [Change AP] on the screen shown for Step 1 to connect the camera to your smartphone via a wireless access point (broadband router).
- Refer to the smartphone instruction manual for further information on how to connect the smartphone.

## ■ Using the smartphone application "LUMIX remote"

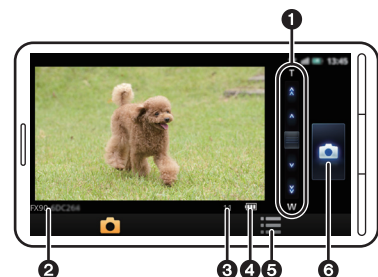

\* The screen differs depending on the operating system.

#### 1 Zoom

- Two zoom speeds are selectable.
- When zooming, a zoom indicator bar appears at the bottom of the recording screen.

#### 2 Name of the connected device

#### 3 Number of recordable pictures

#### 4 Camera battery indication

#### 5 Menu display

#### 6 Shutter

- Pictures are recorded according to the Normal Picture Mode settings on the camera. ([Auto Bracket] and [Burst] are not available.)
- Motion pictures cannot be recorded.
- When [Auto Review] is set to [Hold], each photo is displayed for [2 sec.].

- Read the "Help" in the "LUMIX remote" menu for further details on how to operate.

## ■ Sending recorded pictures to a smartphone

Pictures recorded using the Live Control function are stored in the built-in memory of the camera or on a card.

- To send images to your smartphone, the smartphone application "LUMIX LINK" is required. (For further details, see the operating instructions of your camera.)

### 1 After recording, touch [Send picture] displayed on the camera.

### 2 On your smartphone, start the smartphone application "LUMIX LINK".

- Connectable smartphones are listed on the camera. Touch the destination name and touch [OK].

### 3 Touch the sent images and confirm that the selection frame (yellow) is displayed when you remove your finger.

- Touch the same image again to cancel the selection.
- You can select a number of images.
- All recorded images, including the pictures that are not recorded with Live Control function are displayed.

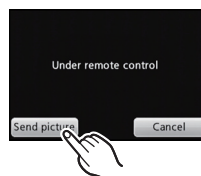

### 4 Drag images upwards in the selected state.

- The sending operation can also be performed by touching [Set].
- All the images selected in step 3 are sent.
- A message is displayed when the image has been sent. Touch [OK].